

SubConn® Power Ethernet Circular

13 contacts

Connector specifications

Voltage rating	600 V DC/AC rms
Voltage rating on data wire	250 V DC/AC rms
Current rating on power wire	4 A per contact (max 16 A per connector)
Data rate	1 Gbit/s (up to 75 m)
Insulation resistance	> 200 Mohm
Contact resistance	< 0.01 ohm
Wet matings	> 500
Temperature rating (water)	- 4 to 60°C, 25 to 140°F
Temperature rating (air)	- 40 to 60°C, - 40 to 140°F
Storage temperature rating	- 40 to 60°C, - 40 to 140°F
Qualified pressure tested	600 bar, 8,700 psi
Depth rating PEEK	300 bar, 4,350 psi

Material specifications

Connector body	Chloroprene rubber
Bulkhead body	Brass, stainless steel, titanium, anodised aluminium or PEEK
Contacts	Female sockets in gold plated brass UNS - C36000 Male pins in gold plated beryllium copper
O-rings	Nitrile
Locking sleeves	POM or stainless steel
Snap rings	Stainless steel AISI 302
Inline cable (3.3 ft, 100 cm)	4 pair 24 AWG, 0.20 mm ² PUR Power conductors 4 x 18 AWG, 0.82 mm ² Screen: Tinned copper braid
Bulkhead and PBOF leads (3.3 ft, 100 cm)	CAT 5E patch cable, 5 x 20 AWG, 0.52 mm ² coloured PTFE incl. RJ 45 connector (not installed)
OM leads (3", 7 cm)	CAT 5E patch cable, 5 x 20 AWG, 0.52 mm ² coloured PTFE

Face view (male)

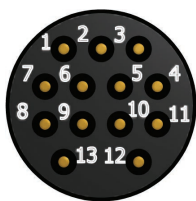

Inline cable colour code

1 Black	4-5 Brown, Brown/white*	10-11 Green, Green/white*
2 Screen (orange wire on bulkhead)	6-7 Blue, Blue/white*	12 Red
3 White	8-9 Orange, Orange/white*	13 Green

* Twisted pairs

Nominal cable outside diameter (OD)

PUR cable 0.550", 13.97 mm

Additional information

Standard RJ45 cannot be mounted on inline cable and will require a RJ45 Phoenix connector or equivalent.

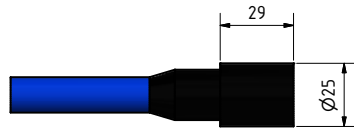

DIL13F

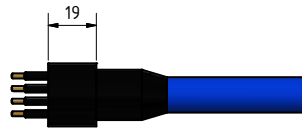

DIL13M

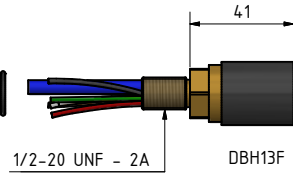
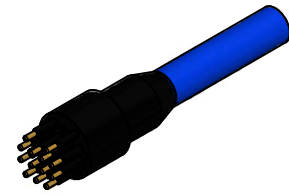

DBH13F

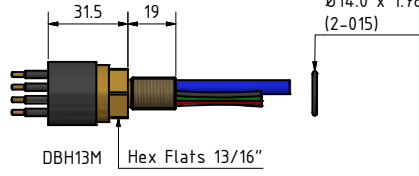

DBH13M

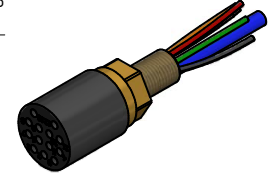

DOM13F



DOM13M

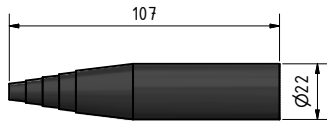
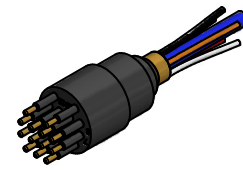

OMBA



OMBA

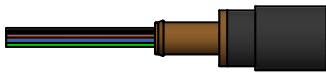
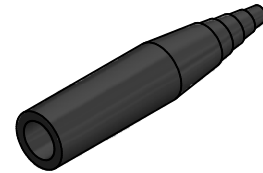

DPB0F13F

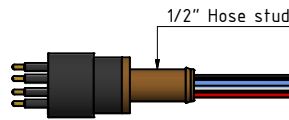

DPB0F13M

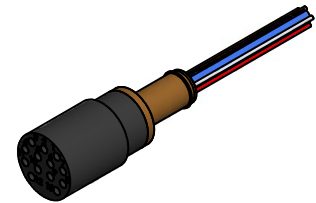

DDC13F



DDC13M

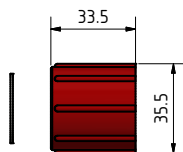
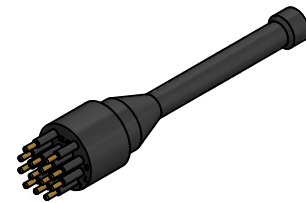

DLSA-F

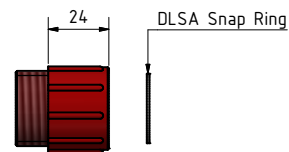

DLSA-M



Drawing information

Dimensions in mm (1 mm = 0.03937 inch)
Threads in inches (1 inch = 25.4 mm)